

CF TYPE

Cam Followers

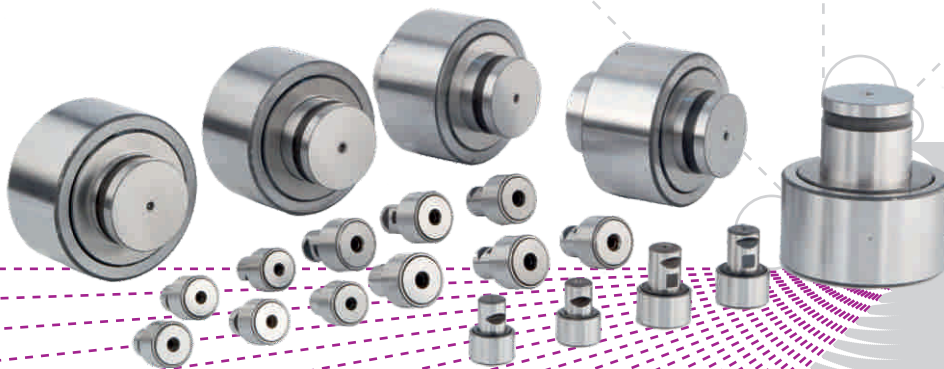

CF

Features & Specifications

CF TYPE Cam Followers

Cam Followers

Packam offers a full range of needle roller cam followers, from 13mm to 101mm outside diameter sizes.

Our Cam Followers are a compact bearing with a high-rigidity shaft and a built-in needle bearing. They are suitable as a guide roller for cam mechanisms and linear motion of automated machines and dedicated machines. Technical innovation and expertise make our cam followers distinctly superior.

Custom sizes and designs available upon request.

Features

- ➔ Full Component for higher capacity
- ➔ Hardened outer, pin and stud
- ➔ CNC ground needle
- ➔ High Precision - Heavy Duty

Technical Specifications

Models:	CF13	CF32	CF64
	CF16	CF35	CF68
	CF19	CF38	CF76
	CF22	CF45	CF90
	CF25	CF50	CF101
	CF28	CF58	

Types:	Stud type (GC) Pin type (PC)
Series:	Short series (SS) Long series (LS)
Special:	Blackoxide coating available on request

Full Code Example

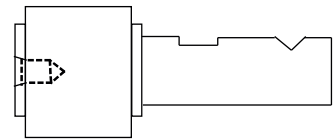
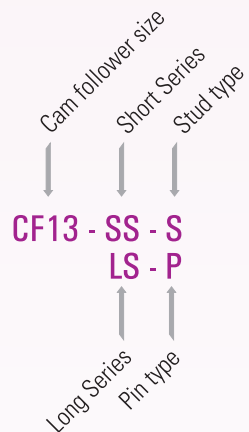

CF

CAM FOLLOWER



CUSTOMISATION



Features & Specifications Standard Models

CF TYPE Cam Followers

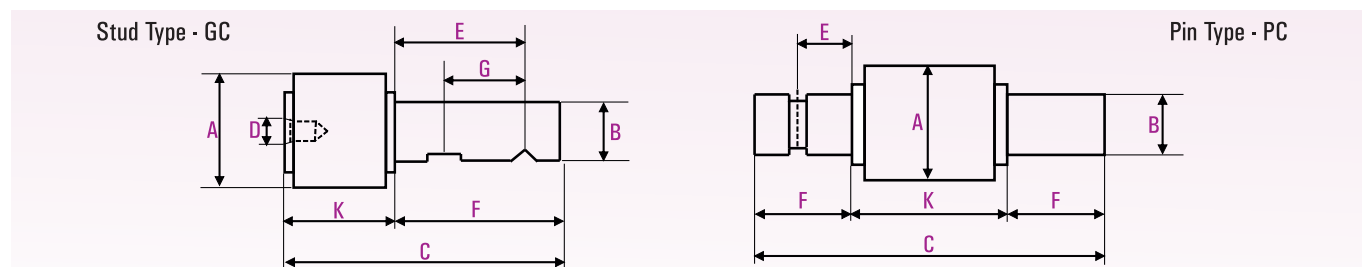

CODE	Size	A [mm]	B [mm]	C [mm]	D [mm]	E [mm]	F [mm]	G [mm]	K [mm]	Radial Play [mm]	Basic Dynamic [N]	Static Capacity [N]
CF13-SS-S	13	12.7	7.019	25	M3	~9.4	14.178	-	10.822	0.028	4400	6000
CF13-LS-S	13	-	-	-	-	-	-	-	-	0.028	4400	6000
CF16-SS-S	16	15.875	7.948	30.16	M3	~8.9	17.345	-	12.815	0.037	6300	7000
CF16-LS-S	16	15.875	7.948	31.74	M3	~14.3	18.8	10.92	12.94	0.037	6300	7000
CF16-SS-P	16	15.875	7.948	25	-	~2.2	6.2	-	12.6	0.037	6300	7000
CF19-SS-S	19	19.05	11.122	31.75	M6	~8.9	17.35	-	14.4	0.025	8400	11000
CF19-LS-S	19	19.05	11.122	36.5	M6	~16.8	22.08	12.192	14.42	0.025	8400	11000
CF19-SS-P	19	19.05	11.122	29	-	~2.7	7.64	-	13.72	0.025	8400	11000
CF22-SS-S	22	22.225	11.122	31.75	M6	~8.9	17.35	-	14.4	0.025	8400	11000
CF22-LS-S	22	22.225	11.122	36.5	M6	~16.8	22.08	12.192	14.42	0.025	8400	11000
CF25-SS-S	25	25.4	15.885	34.92	M6	~7.4	17.32	-	17.6	0.028	11100	18000
CF25-LS-S	25	25.4	15.885	42.85	M6	~19.2	25.2	12.19	17.65	0.028	11100	18000
CF25-SS-P	25	25.4	15.885	33	-	~2.8	7.8	-	17.4	0.028	11100	18000
CF28-SS-S	28	28.575	15.885	34.92	M6	~7.4	17.32	-	17.6	0.028	11100	18000
CF28-LS-S	28	28.575	15.885	42.85	M6	~19.2	25.2	12.19	17.65	0.028	11100	18000
CF28-SS-P	28	28.575	15.885	40	-	~6.3	11.3	-	17.4	0.028	11100	18000
CF32-SS-S	32	31.75	19.06	44.44	M8	~17.3	23.68	10.92	20.76	0.032	18100	25000
CF32-LS-S	32	31.75	19.06	52.39	M8	~19.2	31.7	12.19	20.69	0.032	18100	25000
CF32-SS-P	32	31.75	19.06	37.5	-	~3.8	9.225	-	19.05	0.032	18100	25000
CF35-SS-S	35	34.925	19.06	44.44	M8	~17.3	23.68	10.92	20.76	0.032	18100	25000
CF35-LS-S	35	34.925	19.06	52.39	M8	~19.2	31.7	12.2	20.69	0.032	18100	25000
CF35-SS-P	35	34.925	19.06	37.3	-	~3.9	8.75	-	19.8	0.032	18100	25000
CF38-SS-S	38	38.1	22.238	47.61	M10	~17.3	23.67	10.92	23.94	0.028	27000	35000
CF38-LS-S	38	38.1	22.238	61.9	M10	~27.9	37.9	20.07	24	0.028	27000	35000
CF38-SS-P	38	38.1	22.238	50	-	~5.8	13.35	-	23.3	0.028	27000	35000
CF45-SS-S	45	44.45	25.413	61.91	M10	~28	34.445	20.07	27.465	0.031	31500	50000
CF45-LS-S	45	44.45	25.413	71.43	M10	~33.8	44.1	24.9	27.33	0.031	31500	50000
CF50-SS-S	50	50.8	28.588	68.26	M12	~25.2	34.802	16	33.458	0.035	42252	60000
CF50-LS-S	50	50.8	28.588	84.14	M12	~36.2	50.7	27.94	33.44	0.035	42252	60000
CF50-SS-P	50	50.8	28.588	63.5	-	~7.6	15.15	-	33.2	0.035	42252	60000
CF58-SS-S	58	57.15	28.588	68.26	M12	~25.2	34.802	16	33.458	0.035	42252	60000
CF58-LS-S	58	57.15	28.588	84.14	M12	~36.2	50.7	27.94	33.44	0.035	42252	60000
CF58-SS-P	58	-	-	-	-	-	-	-	-	0.035	42252	60000
CF64-SS-S	64	63.5	31.763	87.31	M12	~36.3	47.51	25.4	39.8	0.038	62800	100000
CF64-LS-S	64	63.5	31.763	96.84	M12	~43.5	56.8	34.29	40.04	0.038	62800	100000
CF64-SS-P	64	63.5	31.763	70	-	~7.2	15.3	-	39.4	0.038	62800	100000
CF68-SS-S	68	68	38.11	98.45	M16	~41.3	54.065	28.575	44.385	0.047	69800	120000
CF76-SS-S	76	76.2	38.11	100	M16	~41.2	53.955	28.575	46.045	0.049	69800	120000
CF76-LS-S	76	76.2	38.11	109.54	M16	~63.5	63.5	38.1	46.04	0.049	69800	120000
CF76-SS-P	76	-	-	-	-	-	-	-	-	0.049	69800	120000
CF90-SS-S	90	88.9	44.463	109.5	M16	~44.2	56.975	28.6	52.525	0.048	95600	125220
CF90-LS-S	90	88.9	44.463	122.2	M16	~53.8	69.7	38.1	52.5	0.048	95600	125220
CF90-SS-P	90	88.9	44.463	95	-	~11	21.35	-	52.3	0.048	95600	125220
CF101-SS-S	101	101.6	55.261	133	M16	~54.7	73.975	38.1	59.025	0.047	131824	303304
CF101-SS-P	101	101.6	55.261	107	-	~12.3	24.55	-	57.9	0.047	131824	303304

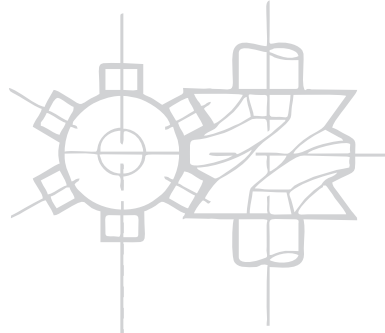

Packam Controls Private Limited
Patel Vanika, Western Express Highway,
Goregaon (East), Mumbai - 400 063, India

T +91 22 61206600
F +91 22 61206606

E info@packam.co.in
U www.packam.co.in

Domestic Sales Enquiry
International Sales Enquiry
After Sales Service

sales@packam.co.in
export@packam.co.in
service@packam.co.in

